

# TIMM PRESERVE

ST. JOSEPH COUNTY PARKS & RECREATION



## WHY ARE WETLANDS IMPORTANT?

Wetlands perform a dazzling array of ecological functions that we have only recently begun to appreciate. A century ago the president of the American Health Association promoted the idea of a national campaign to eliminate wetlands. Today, scientists recognize the environmental benefits that wetlands provide, and they are now alerting us to the importance of preserving rather than eliminating our wetland resources. Your wetland is likely performing vital ecological functions that were barely recognized a few short years ago.

Even now our understanding of the complexities of wetland ecosystems is still developing, and it seems the more we learn, the more valuable wetlands become. Wetland ecologists have already documented the following environmental benefits of wetlands: water purification, flood protection, shoreline stabilization, groundwater recharge, and streamflow maintenance. Wetlands also provide habitat for fish and wildlife, including endangered species. Not all wetlands provide all of these benefits, and how your particular wetland works depends on its location and its type. SOURCE: Department of Ecology: State of Washington: [www.wcy.wa.gov](http://www.wcy.wa.gov)

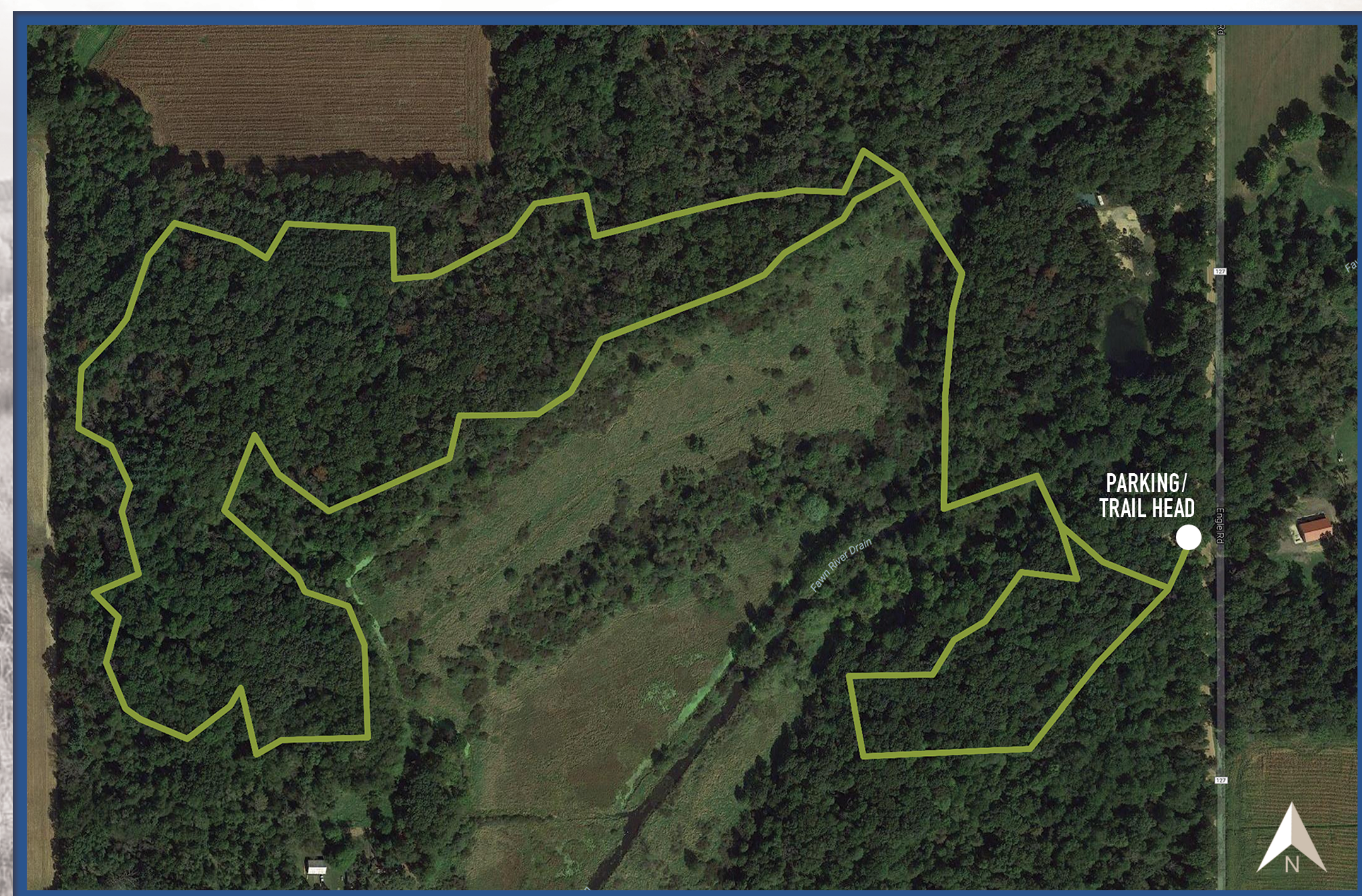

## What can I see?

Be sure to look both high and low for the following wildlife:

VARIOUS NORTH AMERICAN SALAMANDERS



EASTERN MASSASAUGA RATTLESNAKE



WHITETAIL DEER



PILEATED WOODPECKER



REDTAIL HAWK



VARIOUS NORTH AMERICAN FROGS



### LEAVE NOTHING BUT YOUR FOOTPRINTS

The Parks Department would like to encourage you to be conscious of your imprint on our preserve. Please carry out nothing more and nothing less that you carry in.



The land for Timm Preserve was graciously donated by Jim Timm to the St. Joseph County Parks and Recreation Commission in 2002 on condition that it be used solely for conservation & park purposes.

ONLINE INFO

