

Southwest $\frac{1}{4}$ of Southwest $\frac{1}{4}$.
SECTION 1
Town 8 South Range 10 West

Stone Marked *
North 83° 00' East
Centre line of
CHICAGO STREET
Stone Marked *
7 $\frac{1}{2}$ Chains

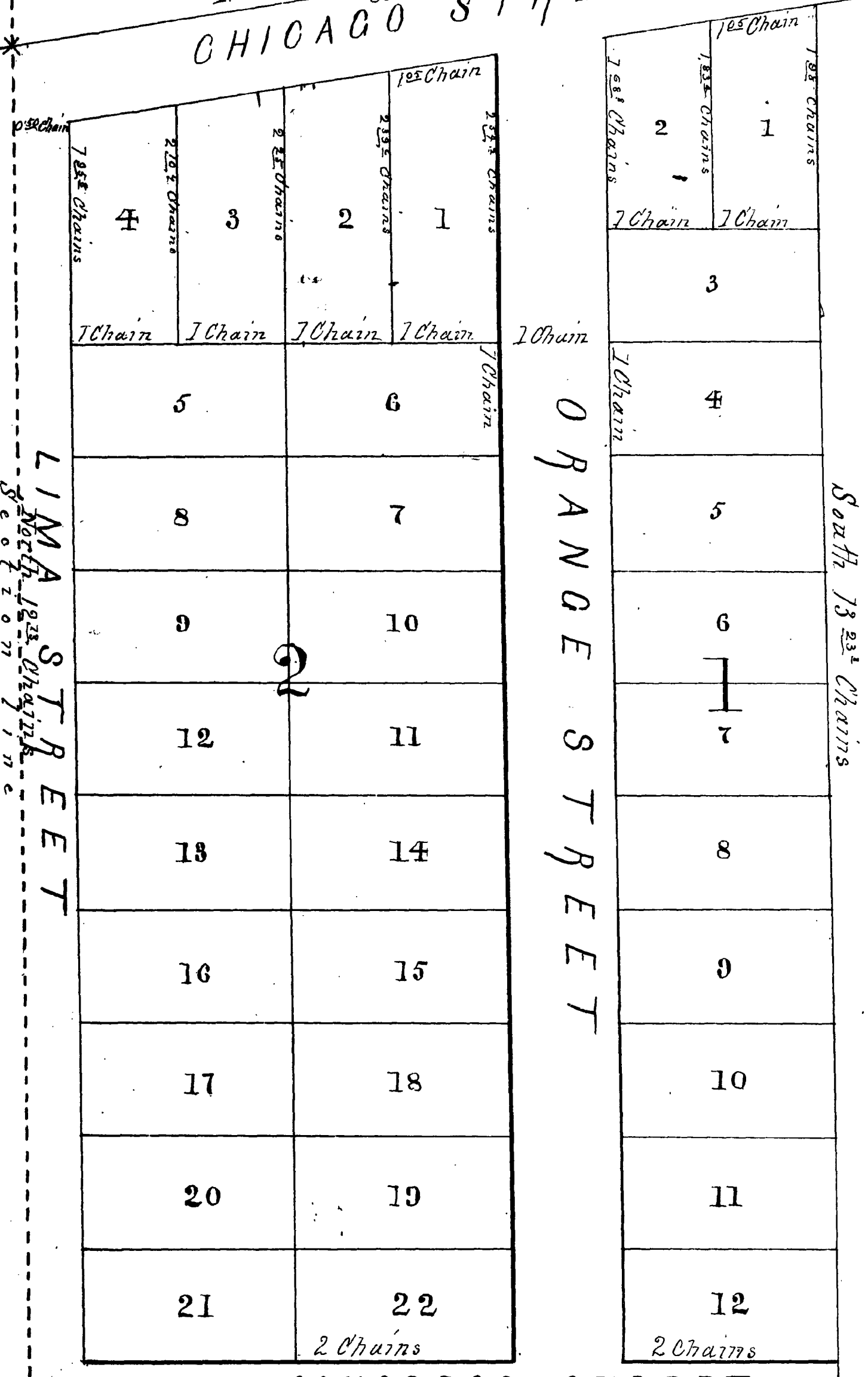

The Park Addition to the Village of Sturgis St. Joseph County State of Michigan, is located on the Southwest quarter of the Southwest quarter of Section One Town eight South Range ten West and is laid out as follows Commencing at the Southwest corner of said Section One, running thence North on the west Section line to 13 chains thence North 83° east seven $\frac{1}{2}$ chains, thence South thirteen $\frac{3}{100}$ chains, thence west along the south Section line seven $\frac{3}{100}$ chains to the place of beginning, all blocks and lots are designated by number, and the sizes of the lots and widths of the streets and their courses are indicated by figures, And we the proprietors of the land embraced in the above description and plat hereby dedicate the streets in said Addition as therein described and platted, to the use of the public.

Witness
Jo A. G. Lapp
Wm. M. Loughlin
Jonathan G. Wait
Susan S. Wait

State of Michigan, S.S.
Notary Public
Personally appeared before me a Notary Public in and for said County, this 15th day of August 1889 Jonathan G. Wait and Susan S. Wait known by me to be the persons who executed the above and severally acknowledged that they did so of their own free will and accord.

Harry A. G. Lapp
Notary Public

I certify that I have carefully surveyed the land embracing the Addition above described and that the foregoing description and the plat hereon drawn, are an accurate description and correct plat of the same as surveyed by me and that I have placed the monuments therein described in the several positions as shown in said plat.

William M. Loughlin
Civil Engineer

Examined and Approved
August 30, 1889
St. P. Pratt
Deputy Auditor General

State of Michigan }
County of St. Joseph } ss. We John B. Handy, Register of Deeds and William M. Loughlin, Surveyor, hereby certify that we have each carefully compared this Copy with the Original Plat of the Park Addition to the Village of Sturgis and that this is an exact Copy thereof and of the whole of such Original Plat for Copy.

John B. Handy, Register of Deeds
William M. Loughlin, Surveyor

Registered Office
St. Joseph County
Recorded for record this 1st day of September 1889 at 4 o'clock P.M. Vol. of Plat on page 9

John B. Handy
Register

PARK ADDITION

to the Village of

STURGIS

Surveyed and Drawn by
William M. Loughlin C.E.

