

WRIGHT'S RESUBDIVISION OF STERLING'S ADD. AND ADDITION TO THREE RIVERS

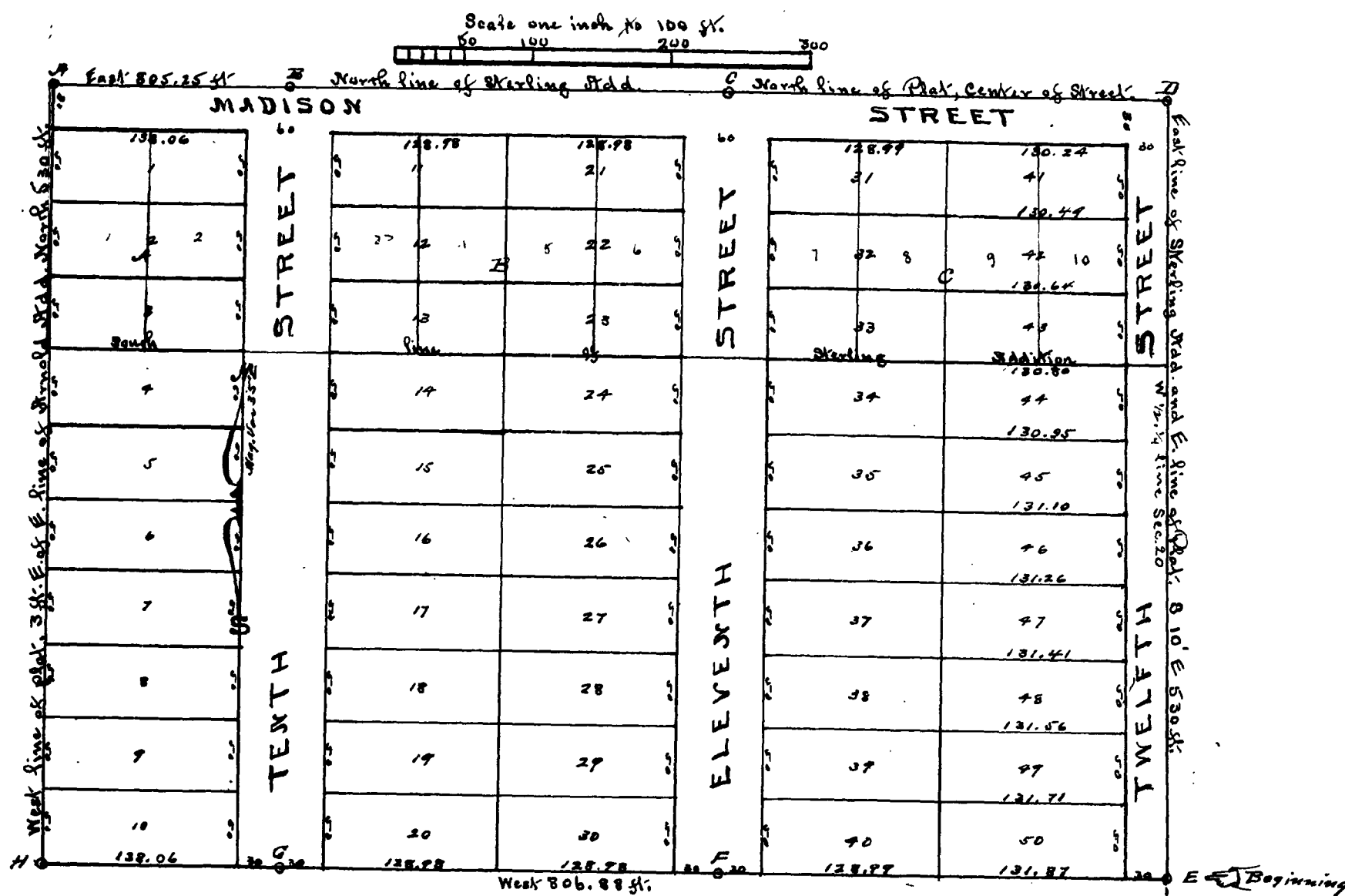

Description
A part of the West half of the N. W. 1/4 of Section 20 Town 6-South Range 11 West, being in St. Joseph County, Michigan and bounded by beginning at a point on the West 1/2 line of Section 20 and north 68 2/3 ft. from the 1/2 line of said section; the plat boundary runs thence West 806.88 ft. to a point 3 ft. East of the Arnold Addition, thence North 530 ft. to the center of Madison St. and at a point 3 ft. East of the N. W. corner of Sterling's Addition to Three Rivers, thence east on the center line of Madison St. being the north line of Sterling's Addition, 805.25 ft. to the E. 1/2 line, and at the N. E. corner of Sterling's Addition, and thence S. 10° E. 530 ft. to place of beginning.

All lines of Sterling's Addition not coinciding with lines of this plat are shown on the plat in red ink. Lot and Block numbers of Sterling's Add. are also given in red.

I, Samuel B. Reed, do hereby certify that I made the survey for the plat herein delineated and that said plat is a correct one and that permanent monuments have been planted at points marked thus (C) with small circles. The monument at C is a stone 4" found in position. The monuments at J, B, D, E, F, Q and X, are 1 in gas pipes 1 1/2 ins long, the monument at D is 1 1/2 ft. E. of stone at B. E. corner of Clarke's Addition, The monuments at J, and X are each 3 ft. E. of the E. line of Arnold's Addition.

Samuel B. Reed Engineer.

Dedication
I know all Men by these Presents, that we John C. Wright and Margaret W. Wright, his wife, jointly, as proprietors have caused the lands embraced in the annexed plat surveyed, laid out and plotted to be known as Wright's Resubdivision of Sterling's Add. and Addition to Three Rivers, and that the streets as shown on said plat are hereby dedicated to the use of the public as follows, in Tenth and Eleventh Sts 15 ft. adjacent to each margin of each street shall be used for walk, tree planting and parking and the remaining 30 ft. in the center of the street shall be used for general road-way; in Twelfth Street the west 15 ft. shall be used for walk, tree planting and parking and the east 15 ft. shall be used for general road-way. All streets, walks and parking to be under control of the City Council. Right to fruit trees reserved 6 months.

Signed and sealed in presence of
 Albert Blodgett
 Samuel B. Reed

John C. Wright
 Margaret W. Wright

State of Michigan } ss.
 County of St. Joseph }
 On this 12th day of April 1907 before me a Notary Public in and for said County, personally John C. Wright and Margaret W. Wright, known to me to be the persons who executed the foregoing dedication and acknowledged the same to be their free act and deed

Samuel B. Reed Notary Public
 My term expires Feb. 14, 1911.

Examined and Approved
 May 10, 1907
 John F. Wilkinson
 Deputy Auditor General.

I hereby certify that I have examined the records in my office relating to the description of lands in the within instrument and from such examination it appears that the State and County taxes have been fully paid for the five years preceding the date of said instrument.

MAY 10 1907
 W. H. VanBuren
 County Treasurer.

REGISTERS OFFICE,
 COUNTY OF ST. JOSEPH.

Received for Record, this 10th day of May A. D. 1907 at 9:00 o'clock A. M., and Recorded in Vol. 1 of Plats of Deeds on Page 143.

W. H. VanBuren
 Register of Deeds

State of Michigan } ss.
 County of St. Joseph }
 We W. H. VanBuren Register of Deeds and Samuel B. Reed, Engineer, hereby certify that we have each carefully compared this copy with the original plat of Wright's Resubdivision of Sterling's Add. and Addition to Three Rivers and that it is an exact copy thereof and of the whole of such original map or plat.

W. H. VanBuren Register of Deeds
Samuel B. Reed Engineer