

Restrictions to Plat Recorded in Liber 361 of Records P 314 & 315

WHITE FAWN SUBDIVISION

A SUBDIVISION SITUATED IN THE EAST 1/2 OF THE SE 1/4 OF SECTION 10,
T 8 S, R 10 W, STURGIS TOWNSHIP, ST. JOSEPH COUNTY, MICH.

CERTIFICATE OF MUNICIPAL APPROVAL

I CERTIFY THAT THIS PLAT WAS APPROVED BY THE TOWNSHIP BOARD OF THE TOWNSHIP OF STURGIS AT A MEETING HELD DECEMBER 4, 1972 AND WAS REVIEWED AND FOUND TO BE IN COMPLIANCE WITH ACT 288, P.A. 1947. THIS PLAT WAS APPROVED ON NOVEMBER 27, 1972 BY THE ST. JOSEPH COUNTY HEALTH DEPARTMENT.

Christine Feller
CHRISTINE FELLER, CLERK

COUNTY DRAIN COMMISSIONER'S CERTIFICATE

APPROVED ON NOV. 29, 1972, AS COMPLYING WITH SECTION 192 OF ACT 288, P.A. 1947 AND THE APPLICABLE PUBLISHED RULES AND REGULATIONS OF MY OFFICE IN THE COUNTY OF ST. JOSEPH.

Lloyd S. Clupp
LLOYD S. CLUPP, DRAIN COMMISSIONER

COUNTY PLAT BOARD CERTIFICATE

THIS PLAT HAS BEEN REVIEWED AND IS APPROVED BY THE ST. JOSEPH COUNTY PLAT BOARD ON DECEMBER 6, 1972 AS BEING IN COMPLIANCE WITH ALL OF THE PROVISIONS OF ACT 288, P.A. 1947 AND THE PLAT BOARD'S APPLICABLE RULES AND REGULATIONS.

Donald E. Dummer
DONALD E. DUMMER,
REGISTER OF DEEDS

Stanley M. Huff
STANLEY M. HUFF,
COUNTY TREASURER

John W. Marvin
JOHN W. MARVIN,
COUNTY CLERK

SURVEYOR'S CERTIFICATE

I, ROBERT E. SAYERS, SURVEYOR, CERTIFY: THAT I HAVE SURVEYED, DIVIDED AND MAPPED THE LAND SHOWN ON THIS PLAT, DESCRIBED AS FOLLOWS: WHITE FAWN SUBDIVISION, A SUBDIVISION SITUATED IN THE EAST 1/2 OF THE SE 1/4 OF SECTION 10, T 8 S, R 10 W, STURGIS TOWNSHIP, ST. JOSEPH COUNTY, MICHIGAN, IS DESCRIBED AS FOLLOWS; COMMENCING AT THE SE CORNER OF SAID SECTION 10 (WHICH IS THE POINT OF BEGINNING) AND RUNNING THENCE NORTH ALONG THE EAST LINE OF SAID SECTION A DISTANCE OF 1636.83 FEET, THENCE S89°44'40"W 233 FEET, THENCE SOUTH 200 FEET, THENCE N89°44'40"E 200 FEET, THENCE SOUTH 66 FEET, THENCE S89°44'40"W 200 FEET, THENCE SOUTH 900 FEET, THENCE N89°44'40"E 200 FEET, THENCE SOUTH 66 FEET, THENCE S89°44'40"W 200 FEET, THENCE SOUTH 200 FEET, THENCE S89°44'40"W 23 FEET, THENCE SOUTH 226.28 FEET TO THE SOUTH LINE OF SAID SECTION 10, THENCE N89°45'15"E ALONG SAID SOUTH SECTION LINE 256 FEET TO THE POINT OF BEGINNING. THIS SUBDIVISION CONTAINS 15 NUMBERED LOTS. THAT I HAVE MADE SUCH SURVEY, LAND DIVISION AND PLAT BY THE DIRECTION OF THE OWNERS OF SUCH LAND. THAT SUCH PLAT IS A CORRECT REPRESENTATION OF ALL THE EXTERIOR BOUNDARIES OF THE LAND SURVEYED AND THE SUBDIVISION OF IT. THAT THE REQUIRED MONUMENTS AND LOT MARKERS HAVE BEEN LOCATED IN THE GROUND AS REQUIRED BY SECTION 125 OF THE ACT. THAT THE ACCURACY OF THE SURVEY IS WITHIN THE LIMITS REQUIRED BY SECTION 126 OF THE ACT. THAT THE BEARINGS SHOWN ON THE PLAT ARE EXPRESSED AS REQUIRED BY SECTION 126 (3) OF THE ACT AND AS EXPLAINED IN THE LEGEND.

Robert E. Sayers
ROBERT E. SAYERS, REGISTERED LAND SURVEYOR #7874
P.O. BOX 212, STURGIS, MICHIGAN, 49091

Nov. 27, 1972
DATE



EXAMINED AND APPROVED

Date Dec. 23, 1972

Allison Green
ALLISON GREEN,
STATE TREASURER
By *Richard E. Lomas*
Richard E. Lomas, Plat Examiner

COUNTY TREASURER'S CERTIFICATE

RECORDS IN MY OFFICE SHOW NO UNPAID TAXES OR SPECIAL ASSESSMENTS FOR THE FIVE YEARS PRECEDING NOVEMBER 28, 1972, INVOLVING THE LANDS INCLUDED IN THIS PLAT.

Stanley M. Huff
STANLEY M. HUFF, ST. JOSEPH COUNTY TREASURER

CERTIFICATE OF COUNTY ROAD COMMISSIONERS

APPROVED ON NOVEMBER 30, 1972 AS COMPLYING WITH SECTIONS 183 OF ACT 288, P.A. 1947, AND THE APPLICABLE PUBLISHED RULES AND REGULATIONS OF THE BOARD OF ROAD COMMISSIONERS OF ST. JOSEPH COUNTY.

Frank Shellenbarger
FRANK SHELLENBARGER, CHAIRMAN

Carl L. Roberts
CARL L. ROBERTS, MEMBER

D.W. Kasey
D.W. KASEY, MEMBER

PROPRIETOR'S CERTIFICATE

WE, AS PROPRIETORS, CERTIFY THAT WE HAVE CAUSED THE LAND ENCOMPASSED IN THIS PLAT TO BE SURVEYED, DIVIDED, MAPPED AND DEDICATED AS REPRESENTED ON THIS PLAT AND THAT PORTION OF WHITE SCHOOL ROAD AND FAWN RIVER ROAD WHICH FALLS WITHIN THE BOUNDARY OF SAID PLAT ARE FOR THE USE OF THE PUBLIC, THAT THE PUBLIC UTILITY EASEMENTS ARE PRIVATE EASEMENTS AND THAT ALL OTHER EASEMENTS ARE FOR THE USES SHOWN ON THE PLAT.

George Andrew Rohrs
GEORGE ANDREW ROHRS
RT. #4, STURGIS, MICHIGAN, 49091

Emma F. Rohrs
EMMA F. ROHRS
RT. #4, STURGIS, MICHIGAN, 49091

Roy E. Penn
ROY E. PENN
RT. #4, STURGIS MICHIGAN, 49091

Wanetta M. Penn
WANETTA M. PENN
RT. #4, STURGIS, MICHIGAN, 49091

Robert E. Sayers
ROBERT E. SAYERS, WITNESS

Jean L. Sayers
JEAN L. SAYERS, WITNESS

ACKNOWLEDGEMENT

STATE OF MICHIGAN
COUNTY OF ST. JOSEPH SS.
PERSONALLY CAME BEFORE ME THIS 25TH DAY OF NOVEMBER, 1972 THE ABOVE NAMED GEORGE ANDREW ROHRS AND EMMA F. ROHRS, HIS WIFE, AND ROY E. PENN AND WANETTA M. PENN, HIS WIFE, TO ME KNOWN TO BE THE PERSONS WHO EXECUTED THE FOREGOING INSTRUMENT AND ACKNOWLEDGED THAT THEY EXECUTED THE SAME AS THEIR FREE ACT AND DEED.

NOTARY PUBLIC *Jean L. Sayers*
JEAN L. SAYERS, ST. JOSEPH COUNTY, MICHIGAN.
MY COMMISSION EXPIRES: MAY 24, 1976

REGISTER OF DEEDS OFFICE
COUNTY OF ST. JOSEPH
THIS PLAT OF WHITE FAWN SUBDIVISION WAS RECORDED THIS 3RD DAY OF JANUARY 1973 AT 2:29 P.M. IN LIBER 5 OF PLATS ON PAGE 218

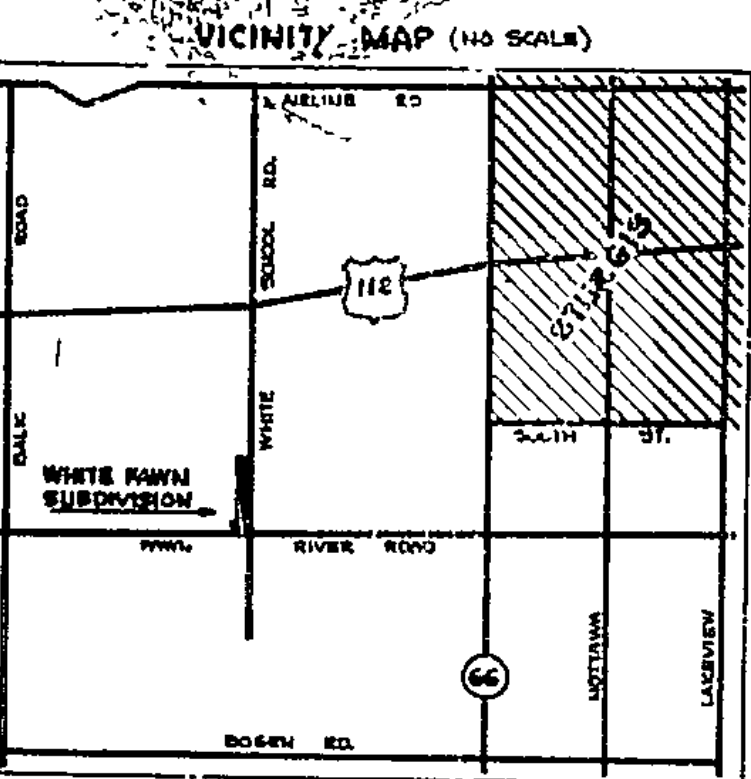

LEGEND

PLOT BEARINGS WERE ESTABLISHED BY THE EAST LINE OF SECTION 10, T 8 S, R 10 W, AS SHOWN ON THE PLAT OF KEN LARGE SUBDIVISION, RECORDED IN LIBER 4 OF PLATS ON PAGE 89. ALL DIMENSIONS ARE IN FEET.
4" CONCRETE MONUMENTS ARE AT ALL POINTS MARKED THIS "0".
ALL LOT CORNERS ARE MARKED BY A 1/2" x 16" SOLID IRON BAR.

SCALE: 1"=100'

