

MAP OF MOORE PARK

St. JOSEPH County Mich.

Surveyed Oct 11th 1874

Philip G. Reinbeck Surveyor Norman D. Andrews Engineer

Scale 5 rods to one inch

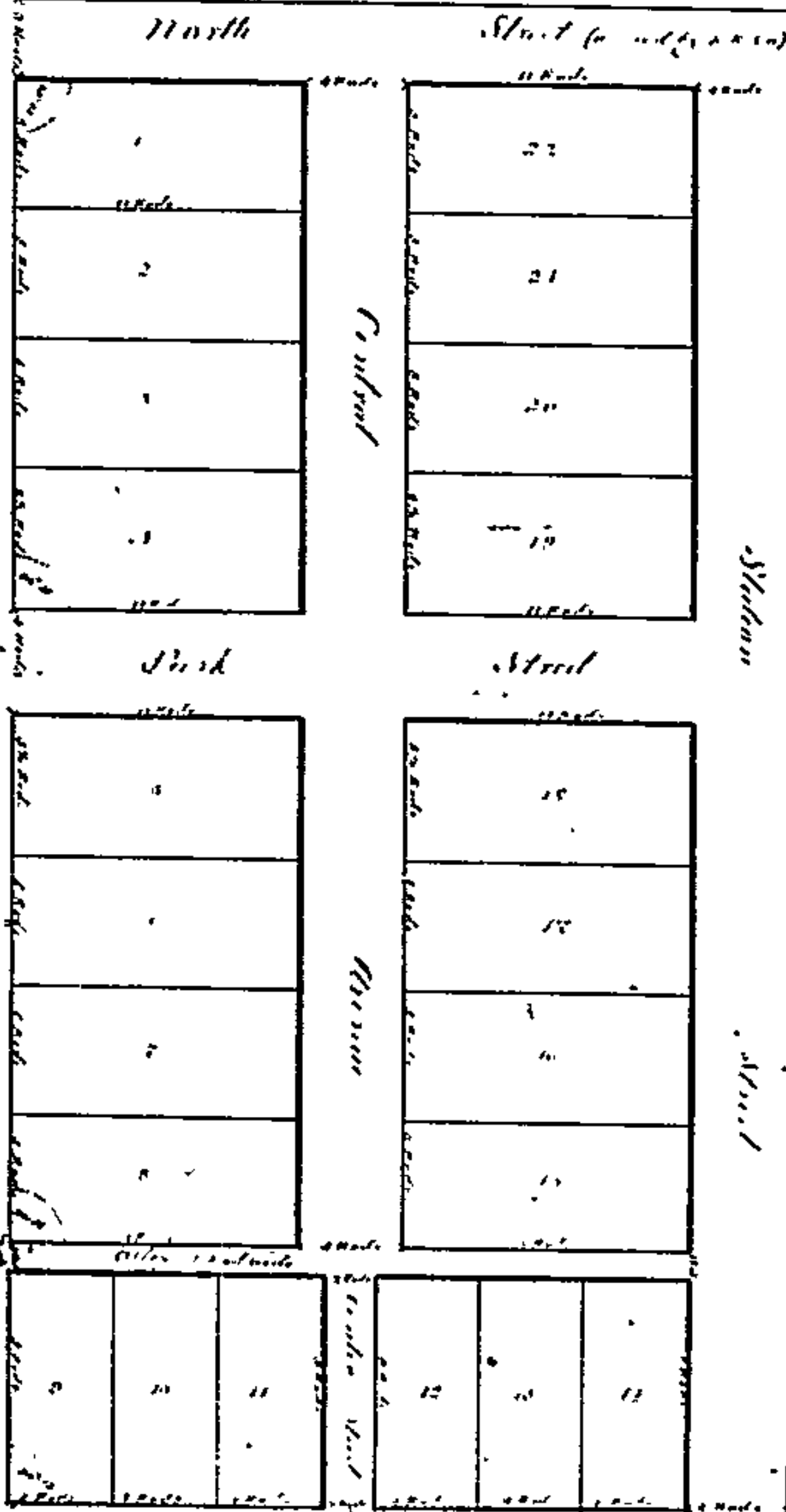

The Village Plat of Moore Park is to be laid upon a part of the West half of the West lot of the South half Quarter of Section 7th 21st Township 22nd Range (S) 5th 5th of Range 11th East (11th) West. The width of Michigan and described as follows Beginning at the S W Corner of the S. B. Quarter of said Section 21st 27th or North along the Quarter line 57 rods thence East to parallel to the South line of said Section 32 rods thence South 57 rods thence West on the Section line 32 rods to place of beginning

The axes of all lots are as the figures upon the outer sides of the lots in the plat. The widths of Streets & alleys are as the figures on the Plat. The streets and alleys are dedicated to the public by this plat. This map made for record designed to comply with the laws in relation to Town & City in such cases made and provided

Philip G. Reinbeck

Norman D. Andrews

Witness my hand and seal this 21st day of March 1874 at St. Joseph Mich.

Notary Public

By M. H. Benedict, Register of Deeds for the County of St. Joseph, State of Michigan and Norman D. Andrews, Engineer & Civil Engineer, who made the plat fully comply with the laws in relation to Town & City in such cases made and provided and the whole of said original Map or Plat

Norman D. Andrews, Engineer
at Cantonville Mich.
March 20th 1874

State of Michigan }
County of St. Joseph }
On this 21st day of March A.D. 1874 before me the undersigned Justice of the Peace for said County personally appeared Philip G. Reinbeck Surveyor and Norman D. Andrews Engineer and who executed the foregoing instrument and acknowledged the same to be their free act and deed

Courtesy E. Collins
Justice of the Peace

City of St. Joseph Mich. - File 533 P. 695
May 1874
533 P. 696
533 P. 697

Original plat deposited by the Land Office to Mich. Southern Plat Book

W. H. P. and Company

